







Codice PBS728 - PBS729

Distanziale maxi in ACCIAIO spazzolato

STRUTTURA

-  **MATERIALE:** acciaio
-  **INDOOR/OUTDOOR**
-  **FISSAGGIO A PARETE**
-  **PANNELLO CON FORI**
-  **FINITURA:** spazzolato
-  **SISTEMA DI CHIUSURA**

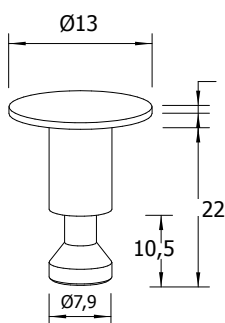

PBS728

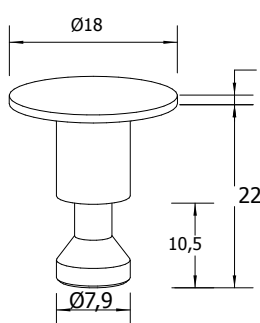

PBS729

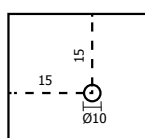
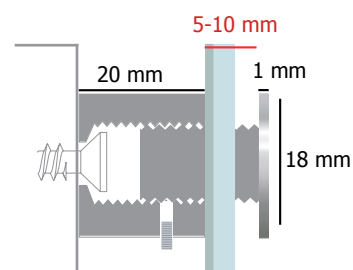
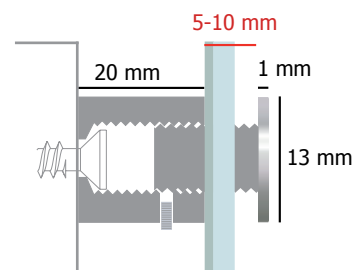

MISURE FORI TARGA

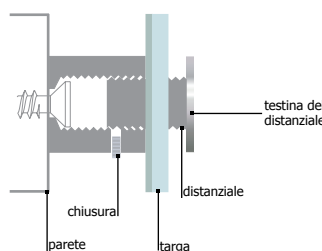

SISTEMA DI FISSAGGIO A MURO

Distanziali in acciaio spazzolato con testina piatta, spessore 1 mm. Ideali per il fissaggio a parete di targhe professionali. Disponibili in due misure 20x13 mm e 20x18 mm. Adatti per targhe con spessore da 5 a 10 mm. Chiusura laterale di sicurezza con grano brugola.

Codice	Dim. struttura	Diametro vite	Finitura	Descrizione
PBS728	20x13	6	Spazzolato	Distanziale in acciaio spazzolato
PBS729	20x18	6	Spazzolato	Distanziale in acciaio spazzolato